



MESTRON

#ThePoleMaker



MCB



SPD

LOOP-IN-LOOP-OUT TERMINATION JUNCTION BOX

MCB 10A + SPD 20kA

Technical Specifications

Brand	: Mestron
Model	: JB-35 SPD
Rated Voltages	: 240V / 415V / 50Hz/60Hz
Rated Connecting Capacity	: Incoming Cable (Maximum 4C x 35mm)
Rated Insulation Voltage	: 500V
IP Rating	: IP 54
Cable Type	: 1 Core 2.5mm x 2 Nos

Miniature Circuit Breaker (MCB 10A)

MCB Type	: JKR Approved Type
Cable Entry	: Two Core (PVC/SWA/PVC Cable)
Type	: Miniature Circuit Breaker Option with Fuse 10A
Reference Standard	: IEC 998 - 1 :1990 & IEC 998 - 2 :1990
Method of Test	: 50,000 Hour (11.5 years based on 12 hours usage everyday)
Life Span	

Surge Protective Device (SPD 20kA)

SPD Model	: ZDL-D20
Max Continuous Operating Voltage (Uc)	: 385 VAC
Voltage Protective Level (Up)	: 1.5 KV
Max Discharging Current (Imax)	: 20 KA
Nominal Discharging Current (In)	: 10 KA
Response Time	: <25 ns
Indication of Invalidation	: Green: Normal, Red: Invalidation
Application	: Several Protection for In Line



Product Dimension

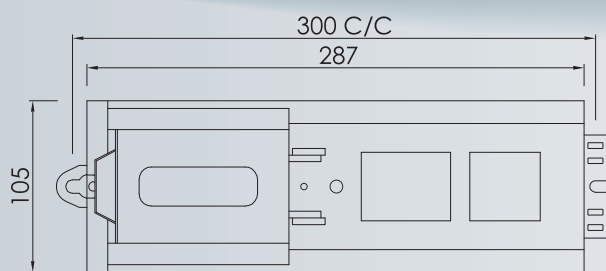

Plan View

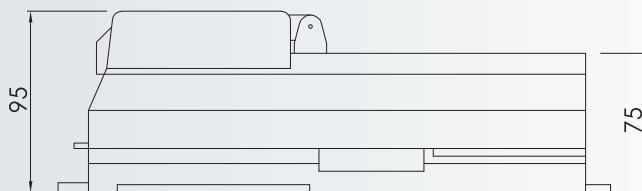

Side View

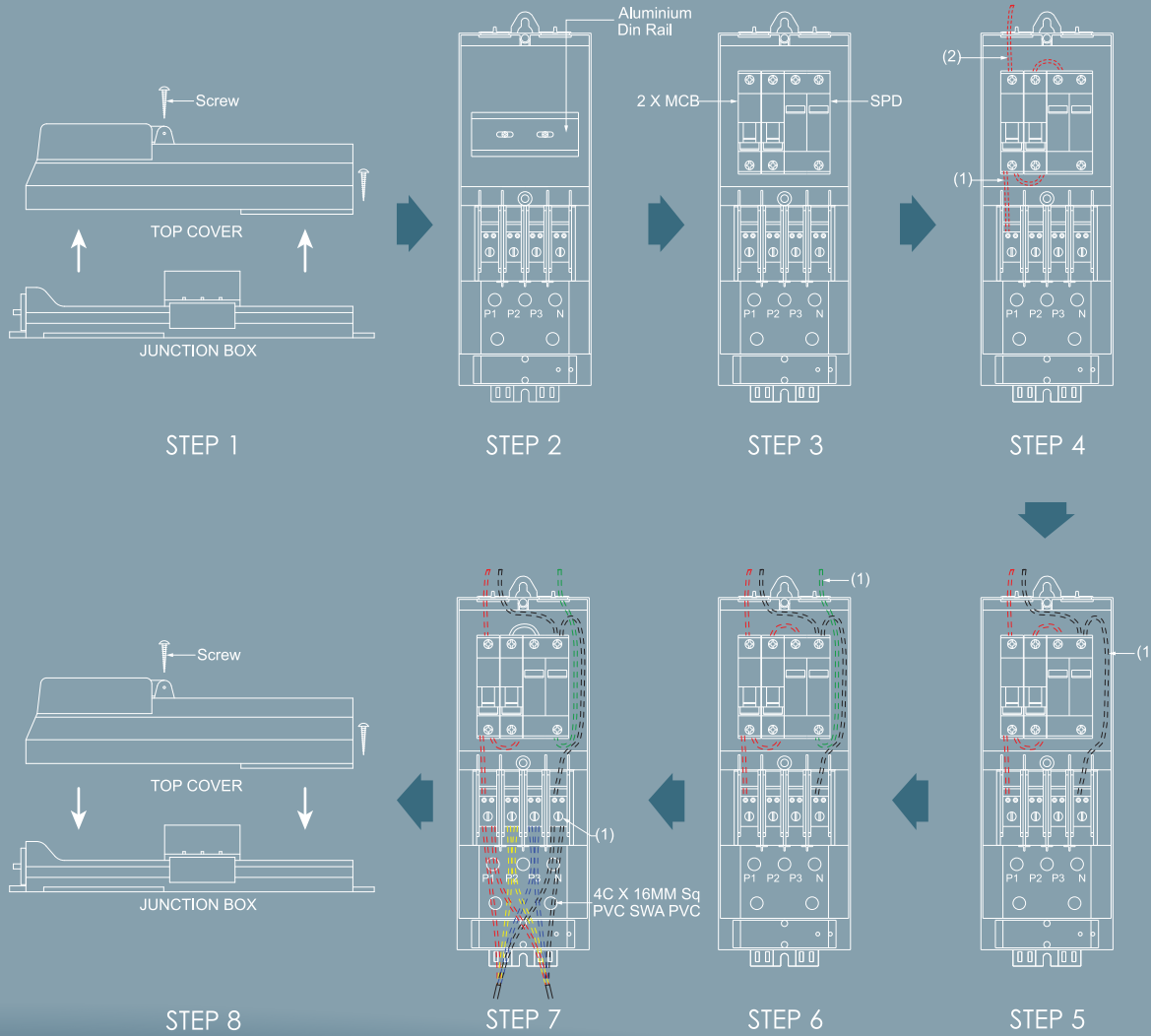

INSTRUCTIONS

- STEP 1** • Unfix the screws
- STEP 2** • Remove the cover of junction box
- STEP 3** • Place the 10A Miniature Circuit Breaker (MCB) and SPD into Aluminium Din Rail
- STEP 4** • (1) INSTALL 1x2.5 Sq mm PVC cable from either P1 or P2 or P3 terminal to both MCB and link to SPD
• (2) Fix 1 x 2.5 Sq mm PVC cable (Live, normally red colour) from street lantern to MCB
- STEP 5** • (1) Fix 1x2.5 Sq mm PVC cable (Neutral, normally black colour) from street lantern to SPD then to terminal "N"
- STEP 6** • (3) Fix 1x2.5 Sq mm PVC cable (Earthing, normally green colour) from SPD to Earth lug on pole
- STEP 7** • 4Cx16mm Sq or 25mm Sq Incoming & Outgoing copper cable will be linked together by copper alloy base terminal P1, P2, P3 or N
• (1) tighten the screw to ensure good connection on cable link
- STEP 8** • Close cover and secure the screw

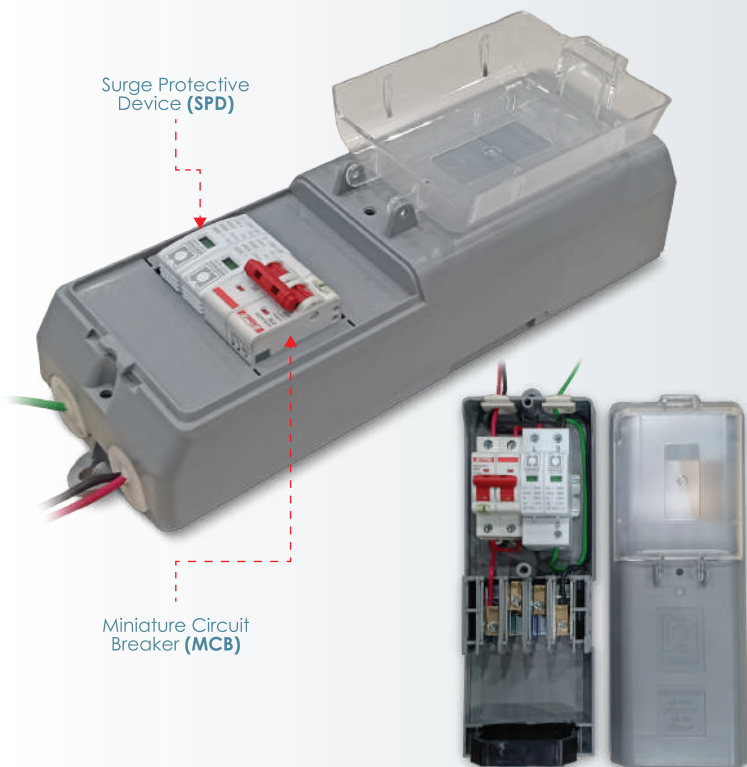

Accreditation

STANDARD AND INDUSTRIAL RESEARCH INSTITUTE OF MALAYSIA (SIRIM)

Licence No : 2015EEA0672

Standard : IEC 60998-2-1 : 2002
IEC 60998-1 : 2002



MALAYSIAN PUBLIC WORKS DEPARTMENT (JKR)

Licence No : 2015EEA0672 & 2015EEA0672-S1

Ref. No : (66)dIm.JKRL(PM) 5/1/4-14 Jilid 8

Standard : IEC 60998-1 : 2002
IEC 60998-2-1 : 2002



MESTRON ENGINEERING SDN BHD 591970-X

PT 50102, Jalan Meranti 1/9, Seksyen 10
Taman Perindustrian Meranti Utama
47120 Puchong, Selangor Darul Ehsan
Malaysia

T : +603 . 8069 1815
F : +603 . 8069 1805
E : info@mestron.com.my
W : www.mestron.com.my

Visit Us :



#ThePoleMaker